

ANCHOR TROLLEY™

User Instruction Manual





WARNING

Read and understand this user instruction manual before using this equipment.

It is the responsibility of the user and the user's management to be certain the user is thoroughly trained in and complies with the proper installation, operation, and limitations.

When used as instructed, the Rigid Lifelines® Anchor Trolley™ can reduce the user's risk of injury from potentially hazardous falls. Misuse of the trolley can result in serious injury or death.

The Anchor Trolley is part of a larger fall protection system. Prior to use, the user must thoroughly read and understand the user instruction manuals that came with the rigid track system, fall arrest safety harnesses, and related equipment.

All fall protection programs are required to include a rescue plan.

As described in the inspection checklists in this user instruction manual, inspect this equipment before each use, after every fall event, and annually.

If the trolley does not roll smoothly because the brakes are engaged, the trolley must be inspected. Remove the trolley from service immediately, even if you do not see the fault indicator.

The swiveling connector, center shaft, and hardened teeth set screws can ONLY be adjusted, serviced, repaired, or replaced by Rigid Lifelines. Do NOT attempt any service to the swiveling connector, center shaft, and hardened teeth set screws.

The hardened teeth set screws are secured with blue Loctite. User attempts at re-adjusting the hardened teeth set screws may cause the trolley to either "drag" or not stop properly during a fall event.

For shortest fall distance, use a self-retracting lanyard with the Anchor Trolley.

DO NOT EXCEED THE OFF-PLUMB (OFF-CENTER) LOADING STATED IN THE ACCOMPANIED SYSTEM MANUAL. THE MAXIMUM OFF-PLUMB LOADING NEVER EXCEEDS 30 DEGREES.

Keep this instruction manual for future reference and new users.

TABLE OF CONTENTS

WARNINGS STATEMENT.....2

STOP THE DRIFT, START THE SELF-RESCUE!.....4

500-SERIES ANCHOR TROLLEY™ COMPONENTS AND KITS.....5

600-SERIES ANCHOR TROLLEY™ COMPONENTS AND KITS.....6

INSTALLATION (INCLUDING RETROFIT).....7

INSPECT BEFORE EACH USE7

MAINTENANCE.....7-8

 General Maintenance.....7

 Track Splice Adjustments8

 Guide Roller Maintenance and Replacement.....8

 Wheel Maintenance and Replacement.....8

ANCHOR TROLLEY™ INSPECTION CHECKLISTS.....9

 1. Before Each Use.....9

 2. Annual and after Every Fall Event.....9

PRODUCT WARRANTY COVERAGE.....10-11

SERVICE POLICY11

ABOUT RIGID LIFELINES®BACK COVER

STOP THE DRIFT, START THE SELF-RESCUE!

The Rigid Lifelines® Anchor Trolley™ is the connection between the user's lanyard and the rigid track fall protection system. The Anchor Trolley follows the user along the full length of the track. User benefits from this unique trolley include:

- Auto-braking that greatly increases the opportunity for self-rescue.
- An exclusive patented anchor design featuring hardened teeth set screws that immediately engage the rigid track, virtually eliminating post-fall drift without damaging the track.
- A swiveling connector that rotates 360 degrees and swivels off-plumb (off-center) to eliminate side-loading stresses.

NOTE: Do not exceed the off-plumb (off-center) loading stated in the accompanied system manual. The maximum off-plumb loading never exceeds 30 degrees.

- Weatherproof, temperature-proof, and lubrication-free operation.
- Wear resistant and long-lasting construction.
- Compatibility with most rigid track.
- Compatibility with enclosed, rigid track that has Mylar™ Lip Seals.

The Anchor Trolley is now standard equipment on all Anchor Track™ Systems from Rigid Lifelines — and it can be retrofitted onto all of our earlier systems.

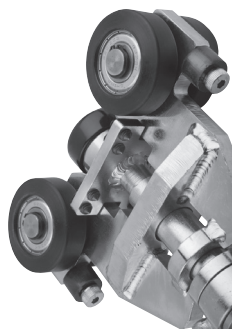
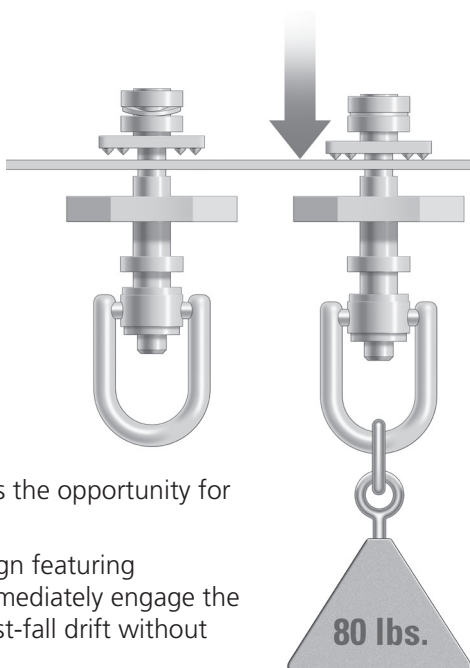

500-SERIES ANCHOR TROLLEY™

COMPONENTS AND SPARE PARTS KITS

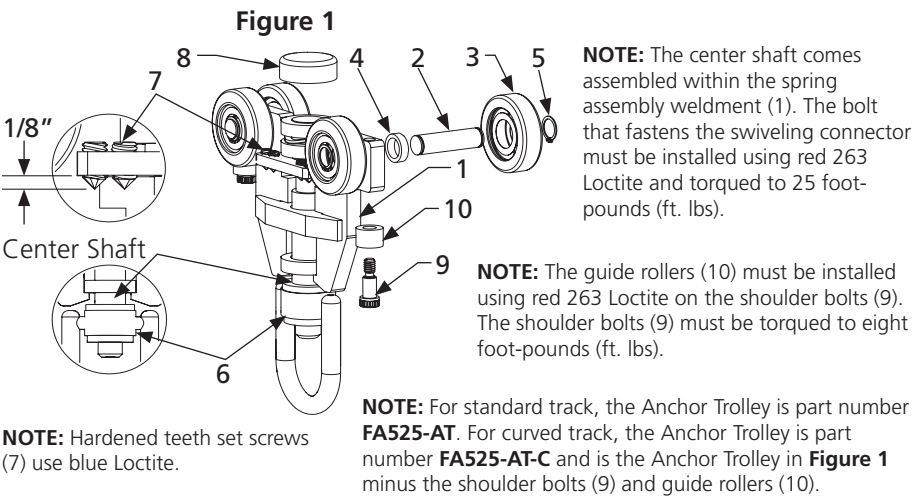

Item	Description	Part Number	Quantity
*1	Spring Assembly Weldment	8-0340	1
2	500-Series Axle	9A1051	2
3	Wheel, 500, Poly	9-1662-5	4
4	500 Axle Spacer	9A1052-1	4
5	Snap Ring	20-0016	4
*6	Swiveling Connector	30-0006	1
*7	Hardened Teeth Set Screws	45-0041	8
8	Dust Cap	8-0341	1
9	Shoulder Bolt (SS)	101-0219-SS	2
10	Guide Roller	26-0028	2

*Factory Service Only

Spare Parts Kits

Description	Part Number
Guide Roller Spare Parts Kit: includes two shoulder bolts (9) and two guide rollers (10).	K-ATR-GR-500
Wheel Spare Parts Kit: includes four wheels (3), four spacers (4), four snap rings (5), and two axles (2).	K-ATR-W-500

Call Rigid Lifelines at 800-869-2080 to order these Spare Parts Kits.

600-SERIES ANCHOR TROLLEY™

COMPONENTS AND SPARE PARTS KITS

NOTE: For standard track, the Anchor Trolley is part number **FA625-AT**.

Figure 2

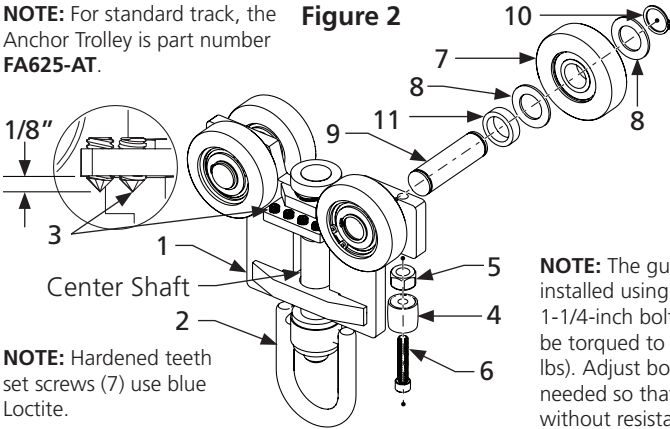

NOTE: The center shaft comes assembled within the spring install (1). The bolt that fastens the swiveling connector must be installed using red 263 Loctite and torqued to 25 foot-pounds (ft. lbs).

NOTE: Hardened teeth set screws (7) use blue Loctite.

NOTE: The guide rollers (4) must be installed using red 263 Loctite on the 1-1/4-inch bolts (6). The bolts (6) must be torqued to eight foot-pounds (ft. lbs). Adjust bolts (6) and hex nuts (5) as needed so that the guide rollers rotate without resistance.

Item	Description	Part Number	Quantity
*1	Spring Install	119-0071	1
*2	Swiveling Connector	30-0006	1
*3	Hardened Teeth Set Screws	45-0041	8
4	Guide Roller	300109-1A	2
5	1/4-Inch Hex Nut	11-0010	2
6	1/4-Inch by 1-1/4-Inch Bolt	44-0013	2
7	6-Inch Wheel Assembly	306111	4
8	Thrust Washer	36-0022	8
9	6-Inch Axle	300102	2
10	Snap Ring	20-0019	4
11	600-Series Spacer	9-1225	4

*Factory Service Only

Spare Parts Kits

Description	Part Number
Guide Roller Spare Parts Kit: includes two bolts (6), two guide rollers (4), and two lock washers (5).	K-ATR-GR-600
Wheel Spare Parts Kit: includes four wheels (7), four spacers (11), four snap rings (10), eight thrust washers (8), and two axles (9).	K-ATR-W-600

Call Rigid Lifelines at 800-869-2080 to order these Spare Parts Kits.

INSTALLATION (INCLUDING RETROFIT)

The Anchor Trolley™ is ready to install right out of the box:

- 1) Remove an end stop from the overhead rigid track.
- 2) Remove the existing trolley.
- 3) Install the new Anchor Trolley.
- 4) Reinstall the track's end stop.

INSPECT BEFORE EACH USE

- 1) Test the operation of the trolley's swiveling connector and verify that the connector can rotate and swivel freely.
- 2) Verify that the trolley can easily traverse the entire length of track and that its wheels rotate freely.

In the unlikely event that the trolley does NOT move easily, this hindered movement could indicate that there is a problem with the anchor's spring mechanism. Inspect the center shaft immediately above the swiveling connector: the center shaft is engineered to produce a fault-indicating groove if there is a spring failure.

If any of these faults occur:

- 1) **The swiveling connector does not rotate or swivel freely, or**
- 2) **The trolley wheels are not moving freely, remove the trolley from service and call Rigid Lifelines at 800-869-2080 for instructions.**

Fault Indicator: a groove appears if there is a spring failure.

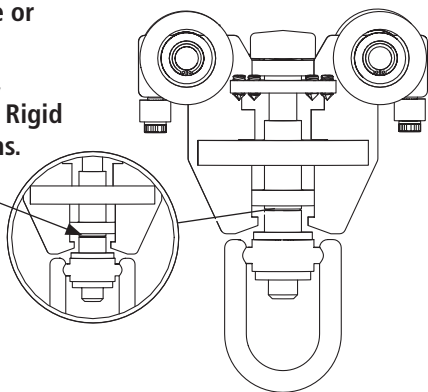

MAINTENANCE

GENERAL MAINTENANCE

- 1) Check the torque on the bolt that fastens the swiveling connector. The torque must be 25 foot-pounds. Use a 3/8-inch hex-key socket to adjust. Never loosen or remove this bolt.
- 2) The Anchor Trolley wheels have sealed bearings and require no lubrication.
- 3) The hardened teeth set screws are factory-set. Do not attempt to re-adjust the set screws; doing so may cause the trolley to either "drag" or not stop properly during a fall event.

TRACK SPLICE ADJUSTMENTS

If the trolley is not moving freely (e.g., “hanging up”) and/or you hear or feel it scraping against the sides of the track, the track’s splices may be too tight. Re-adjust the splices’ set screws so the track is not “pinched” and ensure the trolley moves freely the entire length of the track.

GUIDE ROLLER MAINTENANCE AND REPLACEMENT

If the trolley wheels are moving smoothly but you hear and/or feel metal scraping against the track, check the guide rollers:

- 1) Remove an end stop from the enclosed track and remove the trolley.
- 2) Inspect the two guide rollers: if they are cracked, abraded, or missing, they must be replaced. See page 5 or 6 for Guide Roller Spare Parts Kits.

Replace the guide rollers using a Guide Roller Spare Parts Kit as follows:

- 3) Use a 5/32-inch (500 Series) or 3/16-inch (600 Series) hex-key (Allen®) wrench to loosen the bolt holding the guide roller.
- 4) Remove the bolt and guide roller.
- 5) Install the new guide roller and then the new bolt using blue Loctite.
- 6) Use a 5/32-inch (500 Series) or 3/16-inch (600 Series) hex-key (Allen®) wrench to tighten the bolt holding the guide roller.
- 7) Torque the bolt to eight foot-pounds.

WHEEL MAINTENANCE AND REPLACEMENT

If the trolley is not gliding smoothly and/or you hear metal scraping (and you have already checked both the track splices and the guide rollers as instructed above), inspect the trolley wheels:

- 1) Remove an end stop from the enclosed track and remove the trolley.
- 2) Inspect the four trolley wheels. If they are cracked, abraded, or otherwise worn so they cannot roll smoothly, they must be replaced. See page 5 or 6 for the Wheel Spare Parts Kits.

Replace the trolley wheels using a Wheel Spare Parts Kit as follows:

- 3) **WARNING: Use Protective Eyewear.** Using pliers, remove the snap rings.
- 4) Pull the worn wheels and their spacers off of their axle.
- 5) Pull out and check the axles; if they have been bent or otherwise damaged, replace them with new axles.
- 6) Install the new spacers, new wheels, and new snap rings onto the axles.
- 7) By hand, spin each wheel to ensure that it moves freely.

RIGID LIFELINES® ANCHOR TROLLEY™

INSPECTION CHECKLISTS

Download and print blank checklists at RigidLifelines.com

Inspector Name:

Date:

BEFORE EACH USE	Inspection Result (✓)	
INSPECTION POINTS	PASS	FAIL
1. Test the swiveling connector to verify that it rotates and swivels freely.		
2. Verify that the trolley can easily and smoothly roll the full length of the runway track.		

AFTER A FALL EVENT AND ANNUAL	Inspection Result (✓)	
INSPECTION POINTS	PASS	FAIL
1. Remove the Anchor Trolley and thoroughly inspect the swiveling connector, shaft, and body of the trolley for any signs of damage, bending, misalignment, broken welds, cracks, corrosion or excessive wear that would obviously interfere with the normal performance of the trolley.		
2. Ensure that the bolt connecting the swiveling connector is torqued to 25 foot-pounds. Use a 3/8-inch hex-key socket to adjust. Never loosen or remove this bolt.		
3. Inspect the hardened teeth set screws to assure that the fall did not cause obvious damage to the teeth.		
4. After repeated fall events, an Anchor Trolley may experience wear on its hardened teeth set screws. Such wear could reduce its braking performance, causing the trolley to "skip" slightly. To confirm that there has been no reduction in braking performance, tie rope (NOT your fall arrest lanyard) around the swiveling connector, pull down with at least 80 pounds of force on the rope, and attempt to move the trolley. If the trolley moves at all or skips slightly while braking under at least 80 pounds of continuous force, remove the trolley from service and call Rigid Lifelines at 800-869-2080.		

©2021. All Rights Reserved. All specifications and product designs subject to change without prior notice.

If the Anchor Trolley fails ANY of the above inspection points, immediately remove the trolley from service and call Rigid Lifelines at 800-869-2080 for instructions.

WARNING: The hardened teeth set screws are NOT user-serviceable. Do NOT attempt to re-sharpen worn teeth or re-adjust their set-screws. Hardened teeth set screws can ONLY be replaced at a Rigid Lifelines factory by our trained technicians.

PRODUCT WARRANTY COVERAGE

Rigid Lifelines warrants its products to be free from defects in material and workmanship as follows:

- Engineered Track Equipment, Wearable End Truck Wheels, and Anchor Trolley™ Wheels and Teeth: Ten Years
- Motorized Products and Drive Components and Paint and Finishes for Non-Aluminum Components: Two Years
- Soft Goods, Devices, Connectors, and Accessories: One Year

Ten-Year Warranty Coverage:

- Defects in equipment material and workmanship of manual track systems and equipment
- Only applies to the wearable wheels on end trucks and wearable Anchor Trolley wheels and teeth

Rigid Lifelines warrants its manual Anchor Track™ systems and equipment to be free from defects in material and workmanship for a period of ten (10) years or 20,000 hours, commencing on the date of shipment to the first retail purchaser. This warranty extends only to parts that are not subject to normal wear and tear from use (nonwearable), with the exception that it does apply to the wearable wheels supplied on end trucks and wearable Anchor Trolley wheels and teeth.

Two-Year Warranty Coverage:

- Defects in equipment material and workmanship of motorized systems and equipment
- Paint coatings and finishes for non-aluminum components

Rigid Lifelines warrants motorized equipment to be free from defects in material and workmanship for a period of two (2) years or 4,000 hours, commencing on the date of shipment to the first retail purchaser. Rigid Lifelines warrants its paint and finishes for a period of two (2) years. Warranty claims related to coatings must be accompanied by documentation of the product's application and environmental conditions from time of delivery to time of claim.

One-Year Warranty Coverage:

- Defects in soft goods, devices, connectors, and accessories

Rigid Lifelines warrants fall protection soft goods, devices, connectors, and accessories to be free from defects in material and workmanship for a period of one (1) year, commencing on the date of shipment to the first retail purchaser.

Continued on next page.

WARRANTY TERMS & CONDITIONS

All warranty claims must be approved by Rigid Lifelines before any work is performed. Rigid Lifelines's obligation under this warranty is limited to the replacement or repair of Rigid Lifelines products at the factory or separate location approved by Rigid Lifelines. **Other than the above mentioned warranty, Rigid Lifelines will not honor any other warranties—whether expressed, implied, or statutory—and disclaims any warranties of merchantability or fitness for a particular purpose.** Rigid Lifelines has the right to reject any warranty claim due to harsh and/or inappropriate environmental conditions.

Rigid Lifelines Is Not Liable for:

- Indirect, incidental, or consequential damages including lost profits, operating costs, loss of production, or travel expenses
- Components or accessories not manufactured by Rigid Lifelines (with the exception of soft goods components and accessories sold and warranted by Rigid Lifelines. For such components and accessories, the warranty shall be determined by the terms and conditions of any warranty provided by the manufacturer of such components and accessories.)
- Defective equipment or system failure caused by misuse, negligence, and improper installation or maintenance
- Equipment that has been used in excess of its rated capacity or beyond its service factors
- Rework and modification of any equipment that has been altered without Rigid Lifelines's written authorization
- Freight charges and damage incurred by freight carriers
- Any loss, injury, or damage to persons or property resulting from failure or defective operation of material or equipment
- This warranty is void for any product that is designed to deform or absorb energy during a fall event and needs to be replaced after a fall event has occurred

Reimbursement Disclaimer:

- Written notice of any claimed system defect must be given to Rigid Lifelines within ninety (90) days of shipment.
- All requests for reimbursement must be accompanied by proper documentation.
- Reimbursement is provided in the form of a credit unless otherwise approved by Rigid Lifelines management.
- Reimbursement for labor will be provided at a maximum rate of \$75 per hour.
- All reimbursement is subject to approval by Rigid Lifelines management.

ABOUT RIGID LIFELINES®

OUR MISSION:

Rigid Lifelines is driven by passion for providing our customers with quality, user-friendly solutions to keep workers safer and more productive at elevation.

OUR COMMITMENT

Rigid Lifelines professionals are dedicated to designing and manufacturing a variety of fall protection systems that meet or exceed OSHA requirements and ANSI Z359 code. Our team of engineers and safety professionals combine over 30 years of experience in the fall protection industry to manufacture fall protection systems that utilize the most advanced technology and designs.

Rigid Lifelines production facilities are certified under the ISO 9001:2015 Quality Management System to provide superior quality products. And every welder at Rigid Lifelines is certified to handle steel (D1.1) and aluminum (D1.2) in accordance with the rigorous requirements and lab testing established by the American Welders Society (AWS).

Rigid Lifelines engineers are involved with ANSI Z359 Technical Review Committee and the ANSI Z359.19 Rigid Horizontal Rail Standard. We also participate with the Safety & Health Technology Committee of the Association of Iron & Steel Technology. Our involvement allows us to keep a constant pulse on the trends in both industry practice and government regulation.

OUR PRODUCTION:

All of our systems are designed and manufactured in the United States of America. We have production facilities in Las Vegas, Nevada, and at our headquarters in Morgantown, Pennsylvania.



Morgantown, PA | Las Vegas, NV
Toll Free: (800) 869-2080 | Local: (610) 286-7200
Outside US: 1-610-286-7200 | Fax: (610) 286-0085
RigidLifelines.com | info@RigidLifelines.com

